

Edition 12 / 2010

Ultra-Wide[®] System

OSSTEM[®]
IMPLANT

HEAD OFFICE

8th FL. WorldMeridian Venture Center II, 426-5,
Gasam-dong, Geumcheon-gu, Seoul, Korea
tel_ 02 2016 7000, fax_ 02 2016 7001
homepage_ <http://www.osstem.com>

MANUFACTURER

#507-8, Geoje3-dong, Yeonje-gu
Busan, Korea. Zip_ 611-804
tel_ 051 850 2500
fax_ 051 861 4693

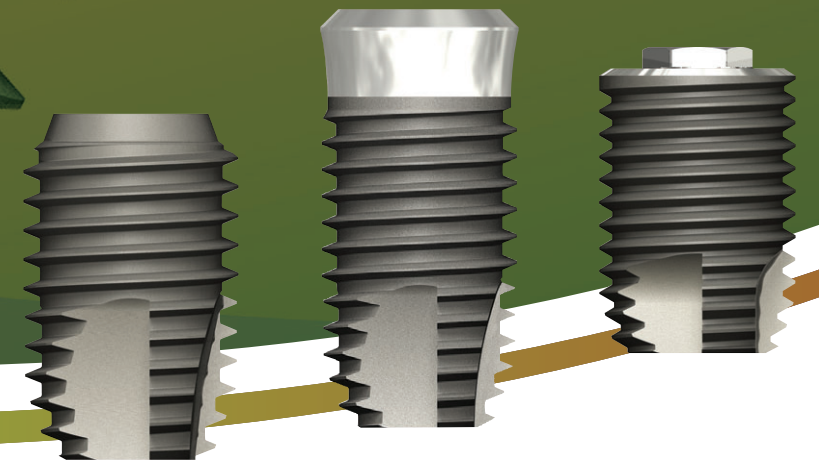

OSSTEM[®]
IMPLANT

Indication of Ultra-Wide® System

Immediate placement at the extraction socket
 Immediate replacement of the failed implant
 Delayed placement in the healed mature bone

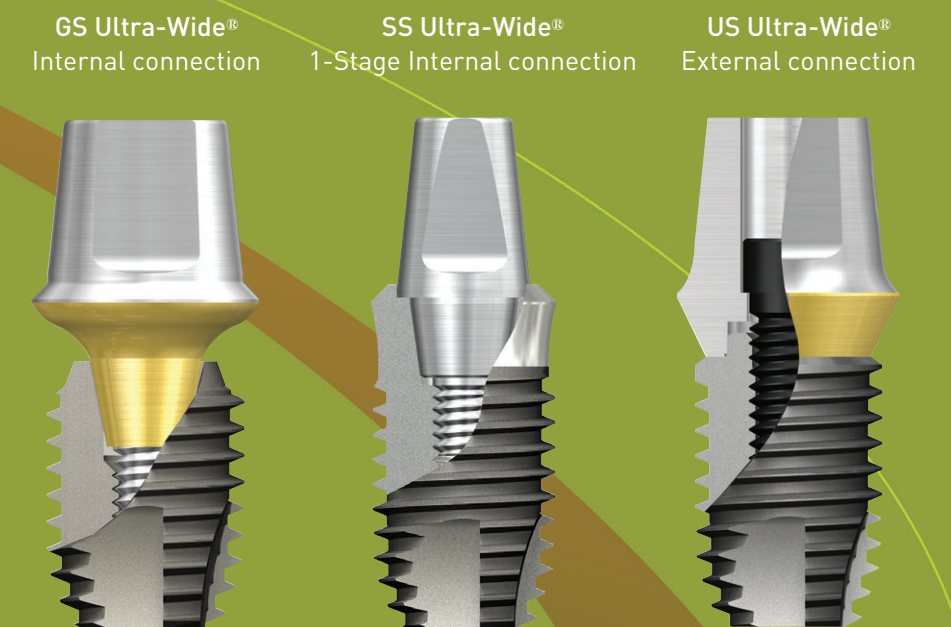

Caution!!! When inserting Ultra-Wide® fixture, maintain more than 1.5mm survival alveolar bone in order to prevent bone loss.

Table of Contents



Indication of Ultra-Wide® System

- 4 **GS Ultra-Wide® System**
- 5 • GS Ultra-Wide® fixture
- 7 • GS Ultra-Wide® abutment



- 8 **SS Ultra-Wide® System**
- 9 • SS Ultra-Wide® fixture
- 1 • SS Ultra-Wide® abutment



- 12 **US Ultra-Wide® System**
- 13 • US Ultra-Wide® fixture
- 15 • US Ultra-Wide® abutment
- 16 **Surgical Procedures**
- 17 • Drilling sequence
- 20 • Insertion depth guide



- 21 **Surgical KIT**
- 21 • Ultra KIT
- 22 • Instrument dimension indication
- 24 **Instruction for Use**

GS Ultra-Wide[£] Fixture

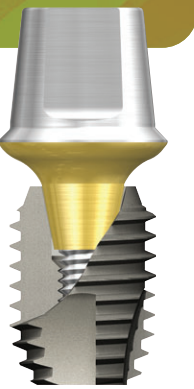

Ultra-Wide[£] System

GS Ultra-Wide[®] System

- GS Ultra-Wide[®] fixture
- GS Ultra-Wide[®] abutment

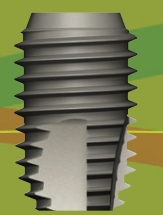

Features of GS Ultra-Wide[£] Fixture

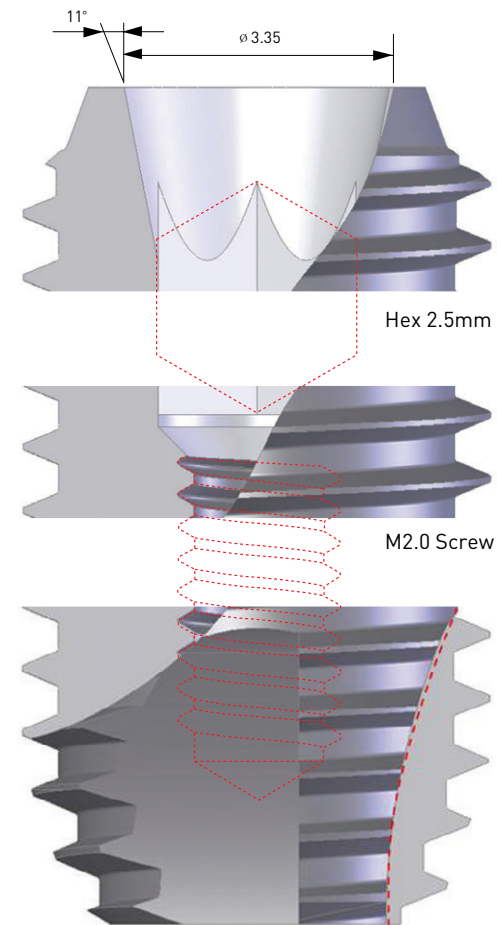

Connection

GS Ultra-Wide[®] fixtures that have a 11° internal connection are compatible with GS standard abutments.

Neck

Bevel neck design of fixture provides more bone volume which is beneficial to minimizing bone resorption and support for aesthetic gingival contour.

Body & Thread

0.8 pitch, 45° angled and 0.45 thread depth provides an enhanced self-tapping ability.

Surface

RBM surface has good biocompatibility which induces secure osseointegration. (Surface roughness Ra: 1.2~1.8_{µm})

Apex

The thread which is existing until apex of fixture and 4 rounded cutting edges provide progressive initial installation ability and good initial stability in immediate placement case.

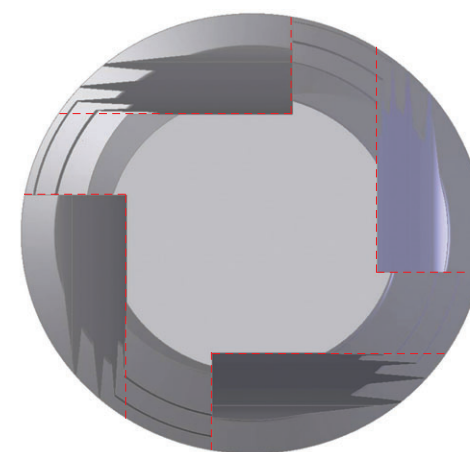

GS Ultra-Wide[®] Fixture

GS Ultra-Wide[®] Abutment

Line-up

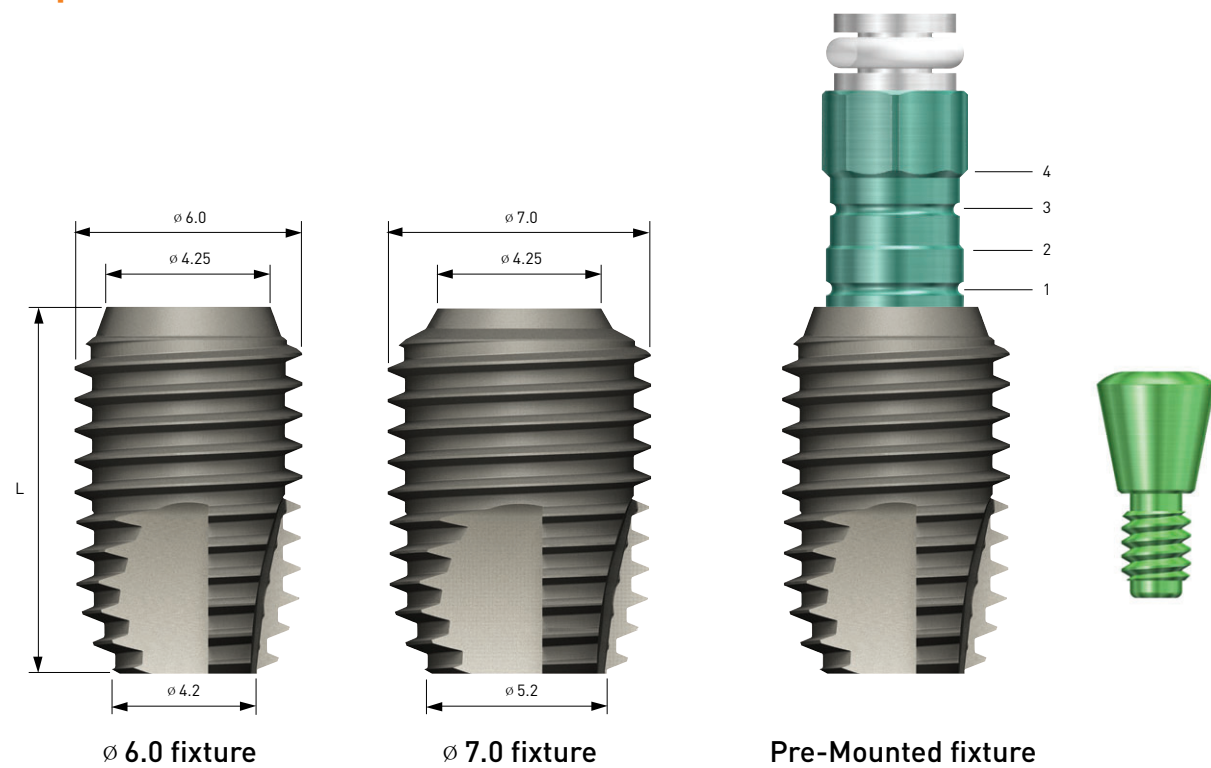

The actual length of GS Ultra-Wide[®] fixture is shorter by 0.5mm than the labeled length for easy control of fixture's insertion depth. (Except for 7mm)

Connection		Standard	
L	D	ø 6.0	ø 7.0
7		GS2W6007R02	GS2W7007R02
8.5		GS2W6008R02	GS2W7008R02
10		GS2W6010R02	GS2W7010R02
11.5		GS2W6011R02	GS2W7011R02
13		GS2W6013R02	GS2W7013R02













Order Code of GS Ultra - Wide[®] Fixture

Fixture Only

- Fixture : Product Code (ex : GS2W6010R02)

Pre-Mounted Fixture

- Fixture + Simple Mount + Cover Screw : B + Product Code (ex : BGS2W6010R02)

Type	Abutments
Cement retained restorations	 Rigid  Transfer  Angled  Freeform ST
	 Freeform  Convertible  Combination cylinder  Combination Angled cylinder
	 GoldCast  Convertible  GoldCast cylinder  Plastic cylinder

Important

1. GS Ultra-Wide[®] fixtures are wholly compatible with GS standard abutment components.
2. Prosthetic procedure is the same as GS prosthetic procedure.
(Refer to "Prosthetic procedure for GS Implant System")

SS Ultra-Wide[®] Fixture

Ultra-Wide[®] System

SS Ultra-Wide[®] System

- SS Ultra-Wide[®] fixture
- SS Ultra-Wide[®] abutment

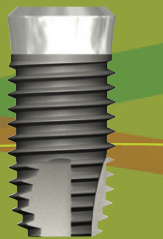

Features of SS Ultra-Wide[®] Fixture

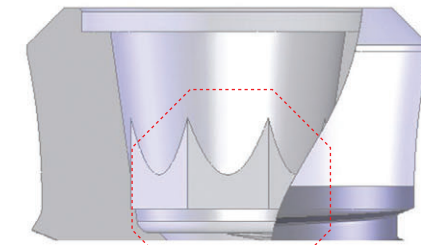

Octa 2.9mm

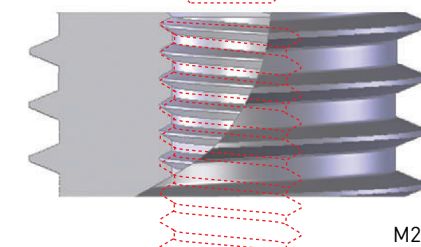

M2.0 Screw

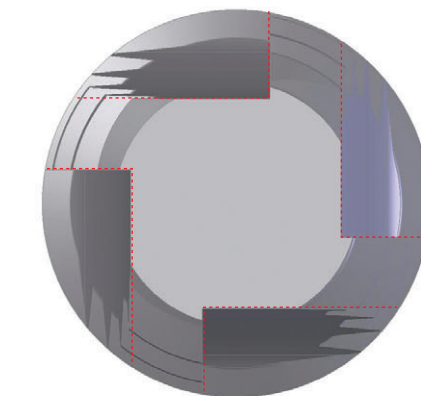
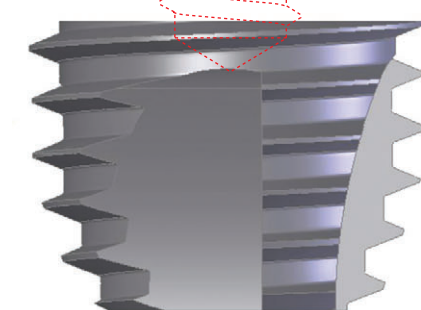

Connection

SS Ultra-Wide[®] fixtures that have a 8° internal connection are compatible with SS wide abutments.

Trans-gingival section

Machined surface facilitates soft tissue management and plaque control.

Neck

Expanded thread of fixture provides an enhanced initial stability.

Body & Thread

0.8 pitch, 45° angle and 0.45 thread depth provides an enhanced self-tapping ability.

Surface

RBM surface has good biocompatibility which induces secure osseointegration. (Surface roughness Ra: 1.2~1.8 μ m)

Apex

The thread which is existing until apex of fixture and 4 rounded cutting edges provide progressive initial installation ability and good initial stability in immediate placement case.

SS Ultra-Wide[®] Fixture

SS Ultra-Wide[®] Abutment

Line-up

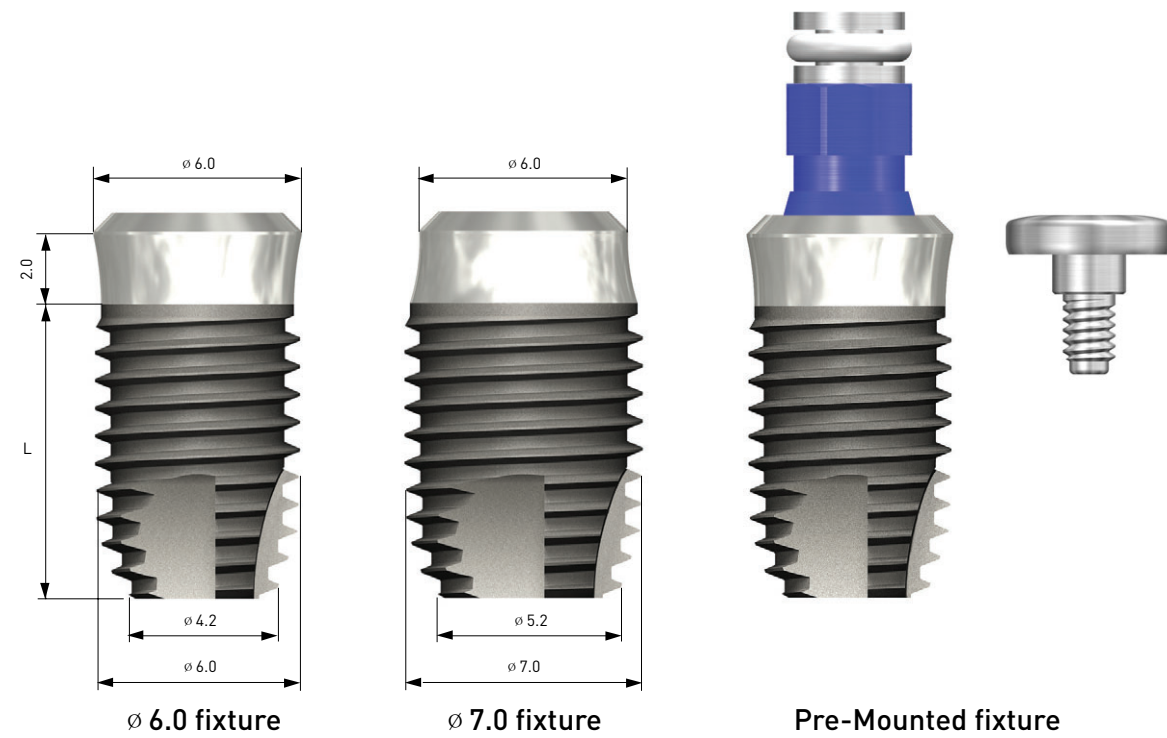

Platform		Wide	
G/H		2.0	
L	D	ø 6.0	ø 7.0
7		SS2WB62007A	SS2WB72007A
8.5		SS2WB62008A	SS2WB72008A
10		SS2WB62010A	SS2WB72010A
11.5		SS2WB62011A	SS2WB72011A
13		SS2WB62013A	SS2WB72013A

Order Code of SS Ultra - Wide[®] Fixture

Fixture Only

- Fixture : Product Code (ex: SS2WB62007A)

Pre-Mounted Fixture

- Fixture + Simple Mount + Cover Screw : A + Product Code (ex : ASS2WB62007A)

Type	Abutments			
Cement retained restorations	Solid	Excellent Solid	Com Octa	
	Com Octa Plus	Hanaro	Com Octa Angled	
Screw retained restorations	Com Octa Gold	Octa	Octa gold cylinder	Octa plastic cylinder

Important

1. SS Ultra-Wide[®] fixtures are wholly compatible with SS wide abutment components.
2. Prosthetic procedure is the same as SS prosthetic procedure.
(Refer to "Prosthetic procedure for SS Implant System")

US Ultra-Wide[®] Fixture



Ultra-Wide[®] System

US Ultra-Wide[®] System

- US Ultra-Wide[®] fixture
- US Ultra-Wide[®] abutment



Features of US Ultra-Wide[®] fixture

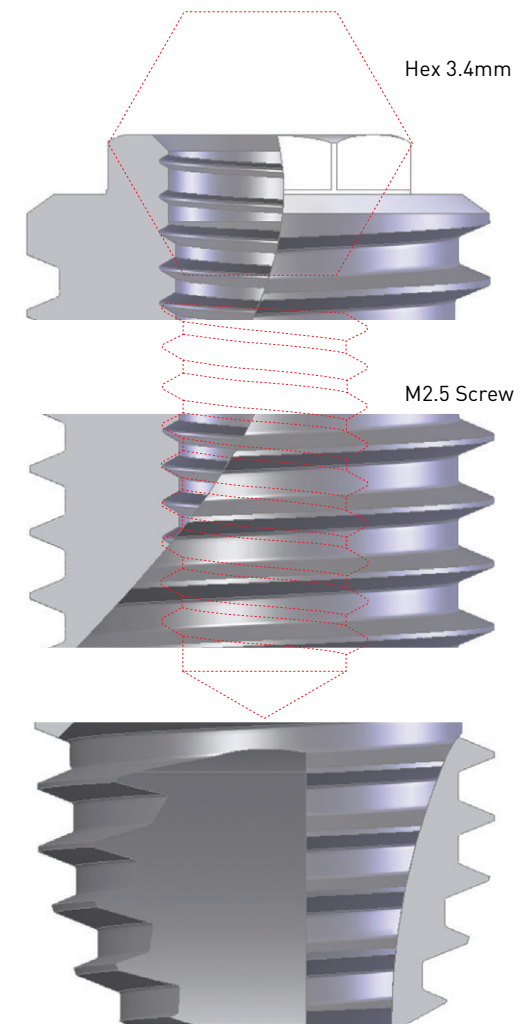

Connection

US Ultra-Wide[®] fixtures that have a 3.4mm external hex connection are compatible with US wide abutments.

Neck

Platform switching effect of fixture minimizes bone resorption and offers an aesthetic result.

Body & Thread

0.8 pitch, 45° angle and 0.45 thread depth provides a good self tapping ability. Expanded thread of fixture provides an enhanced initial stability.

Surface

RBM surface has good biocompatibility which induces secure osseointegration. (Surface roughness Ra: 1.2~1.8 μ m)

Apex

The thread which is existing until apex of fixture and 4 rounded cutting edges provide progressive initial installation ability and good initial stability in immediate placement case.

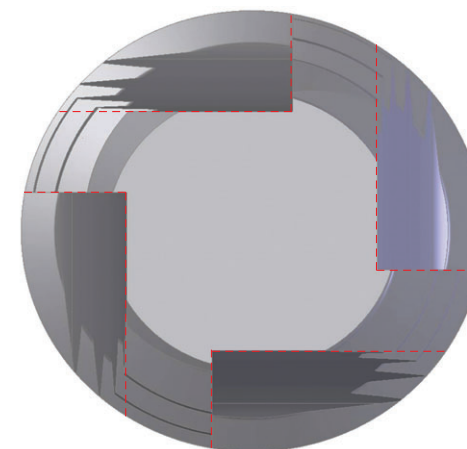

US Ultra-Wide[®] Fixture

US Ultra-Wide[®] Abutment

Line-up

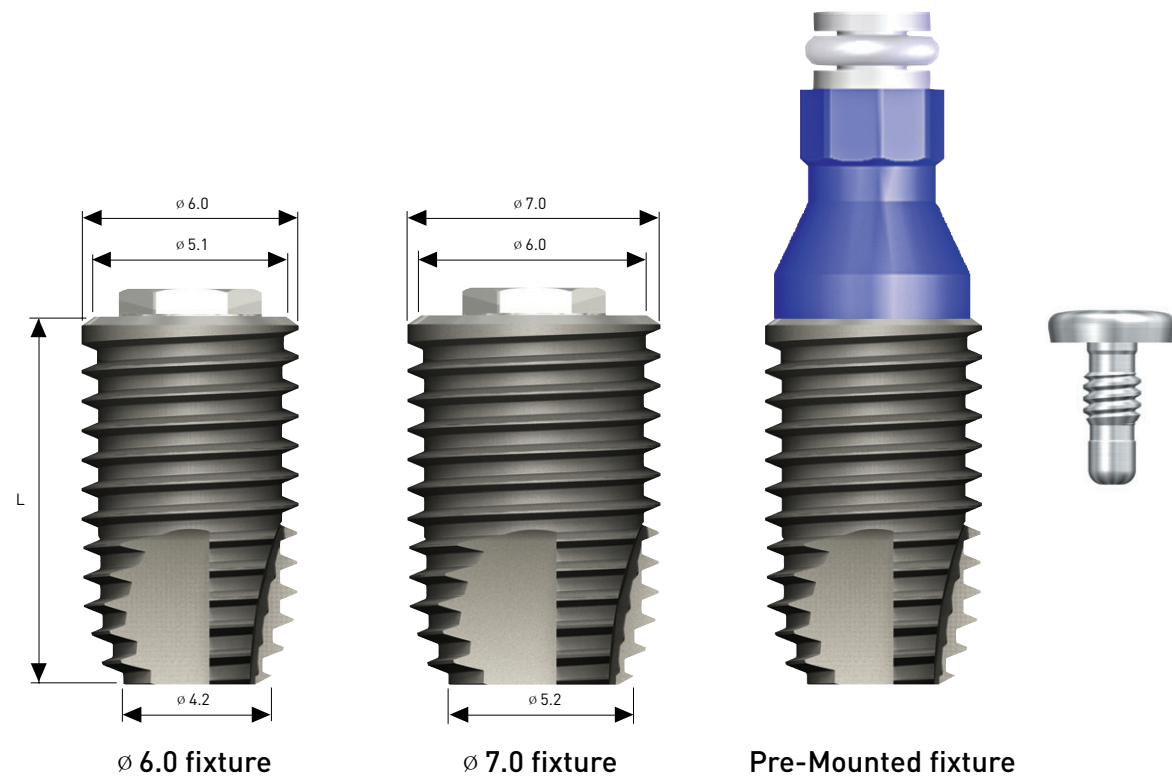

Platform		Wide	
L	D	6.0	7.0
7		BFW6007A	BFW7007A
8.5		BFW6008A	BFW7008A
10		BFW6010A	BFW7010A
11.5		BFW6011A	BFW7011A
13		BFW6013A	BFW7013A

Order Code of US Ultra - Wide[®] Fixture

Fixture Only

- Fixture : Product Code (ex : BFW6007A)

Pre-Mounted Fixture

- Fixture + Simple Mount + Cover Screw : A + Product Code (ex : ABFW6007A)

Type	Abutments
Cement retained restorations	<p>Cement Angled Safe</p>
Screw retained restorations	<p>UCLA Esthetic-low Esthetic-low gold cylinder Esthetic-low plastic cylinder</p>
Combination retained restorations	<p>ER</p>

Important

1. US Ultra-Wide[®] fixtures are wholly compatible with US wide abutment components.
2. Prosthetic procedure is the same as US prosthetic procedure.
(Refer to "Prosthetic procedure for US Implant System")

Drilling sequence for Ultra-Wide[£] Fixture

Ultra-Wide[£] System

Surgical Procedures

GS, SS and US Ultra-Wide[®] fixture use the same drilling sequence and surgical instruments which is included in Ultra Kit, and it provides a convenient implant placement.



Drilling sequence with Trepine drill

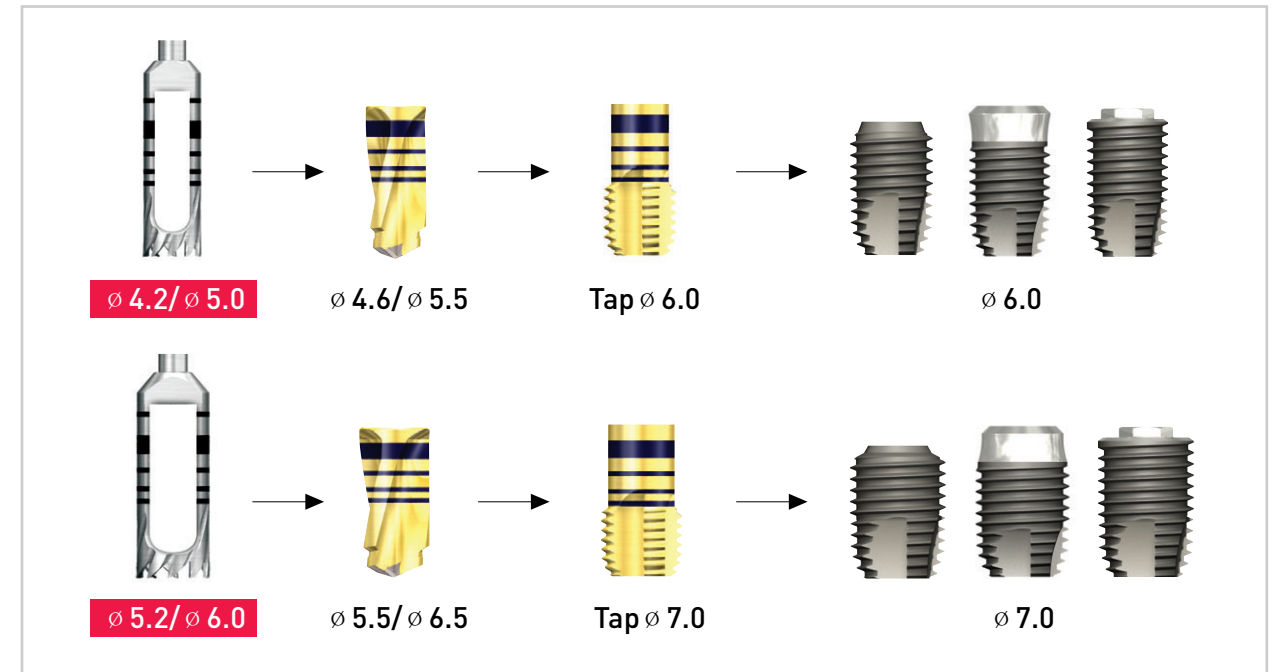

Conventional drilling sequence

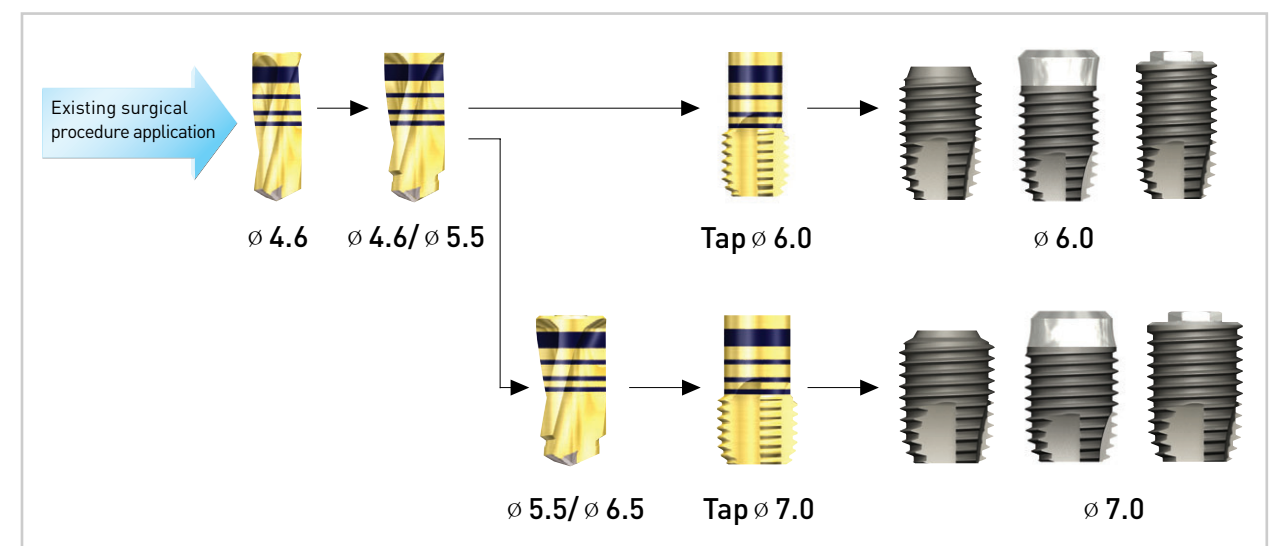

※ When bone is especially hard(D1), the Surgical Tap must be used.

Surgical procedure with Trepine drill

* Immediate placement at the extraction socket

□ 6.0 Ultra-Wide[®] fixture, Length : 10mm

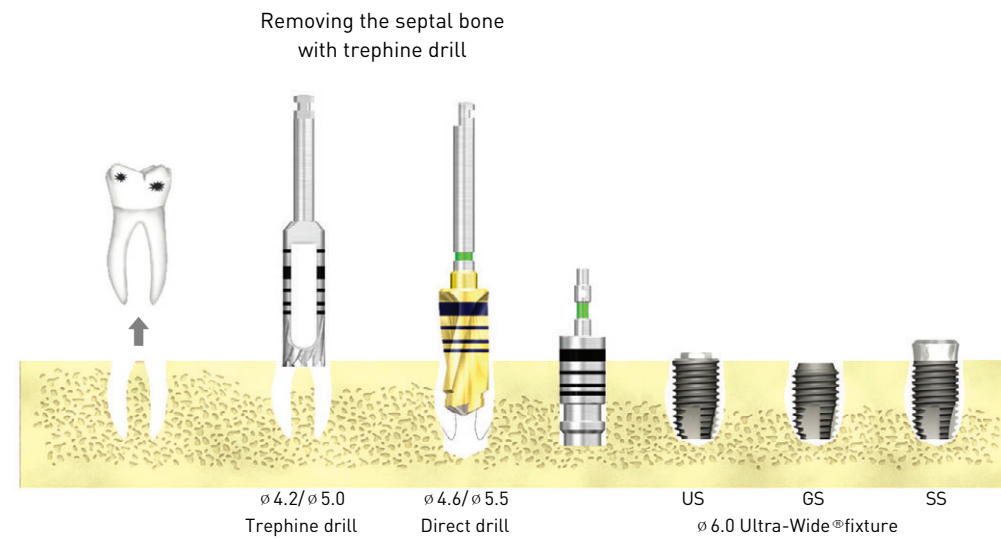

* Immediate replacement of the failed implant

□ 6.0 Ultra-Wide[®] fixture, Length : 10mm

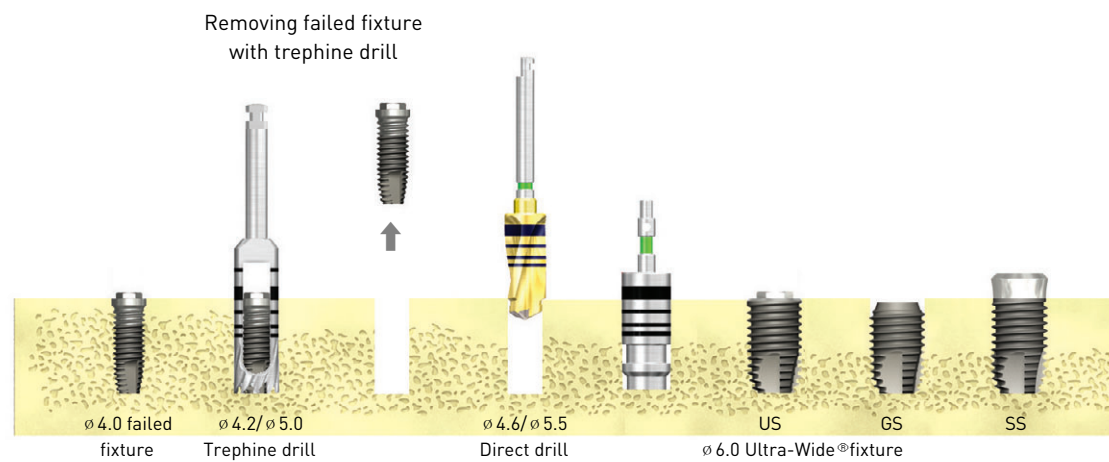

Surgical procedure with Trepine drill

* Delayed placement in the healed mature bone

□ 6.0 Ultra-Wide[®] fixture, Length : 10mm

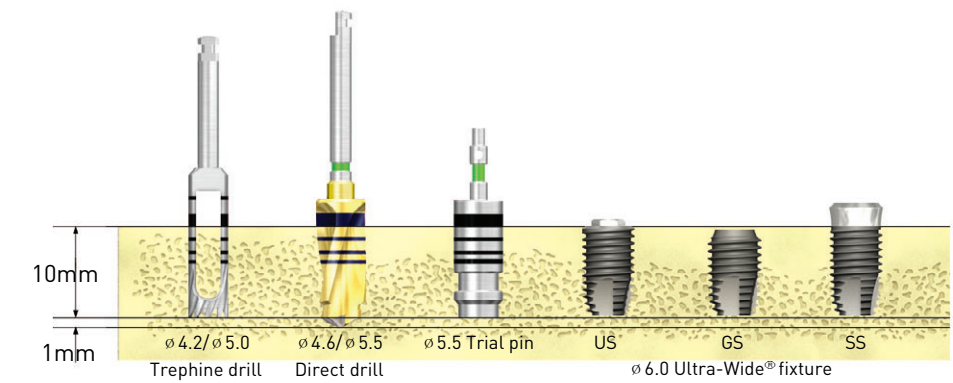

* Conventional drilling sequence

□ 6.0 Ultra-Wide[®] fixture, Length : 10mm

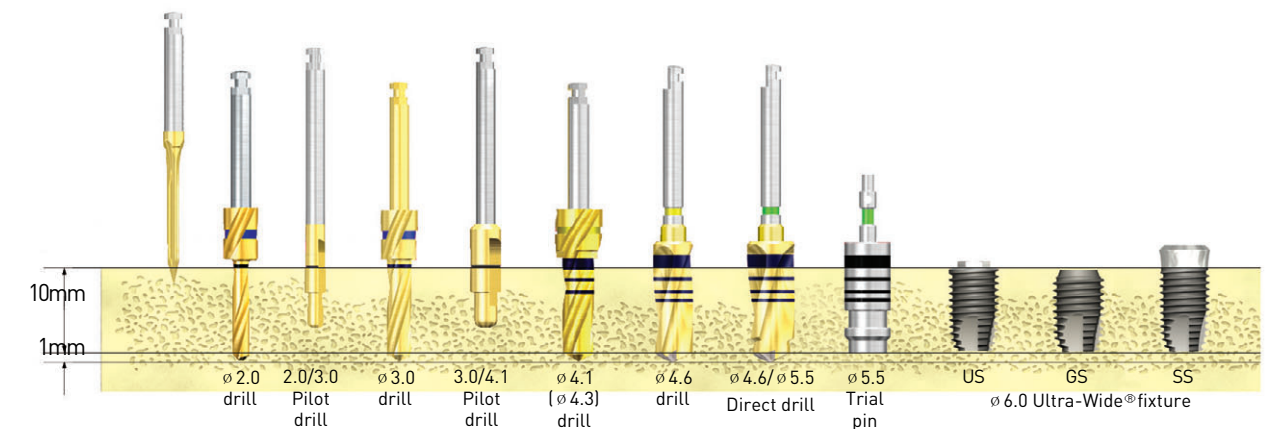

- Surgical tap is recommended in case of hard bone.
- Verify the depth with Trial pin after final drilling.
- Recommended rpm of Trepine drill : 800~1000rpm
Recommended rpm of drilling : 800~1500rpm
Recommended rpm of tapping : below 20rpm

Insertion Depth Guide

- GS Ultra-Wide[®] ; 0.5~1mm Sub-Crestal
- SS Ultra-Wide[®] ; Correspond with Bone Level
- US Ultra-Wide[®] ; 0.25mm Supra-Crestal

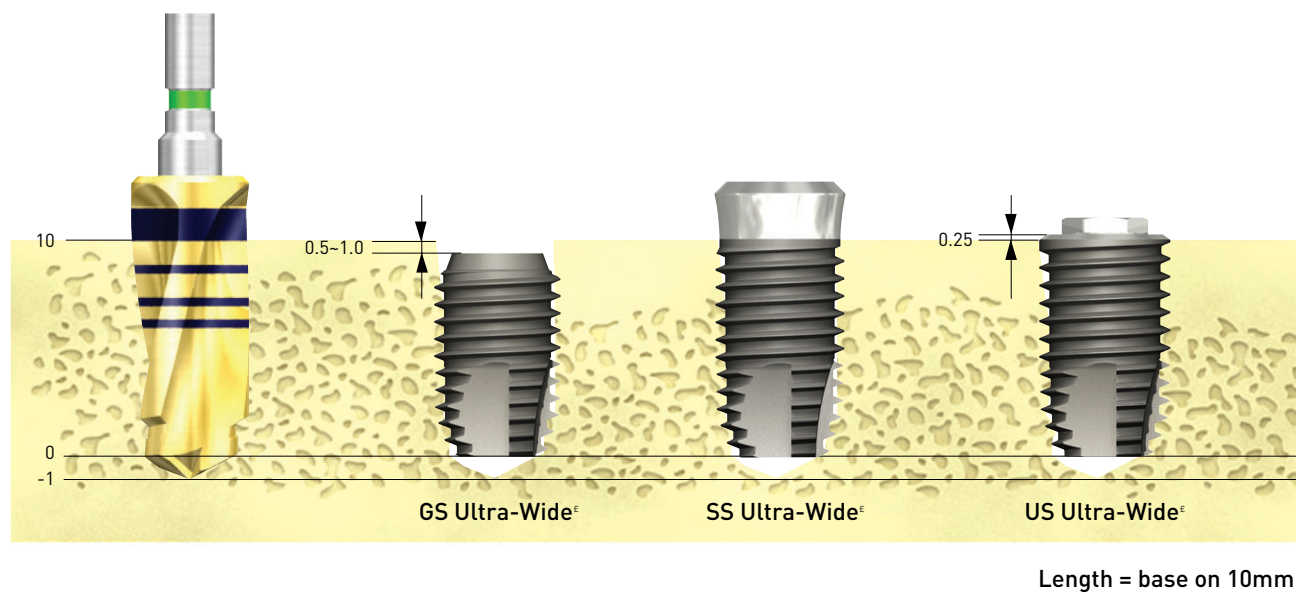

Surgical KIT

* Ultra KIT(OUK)

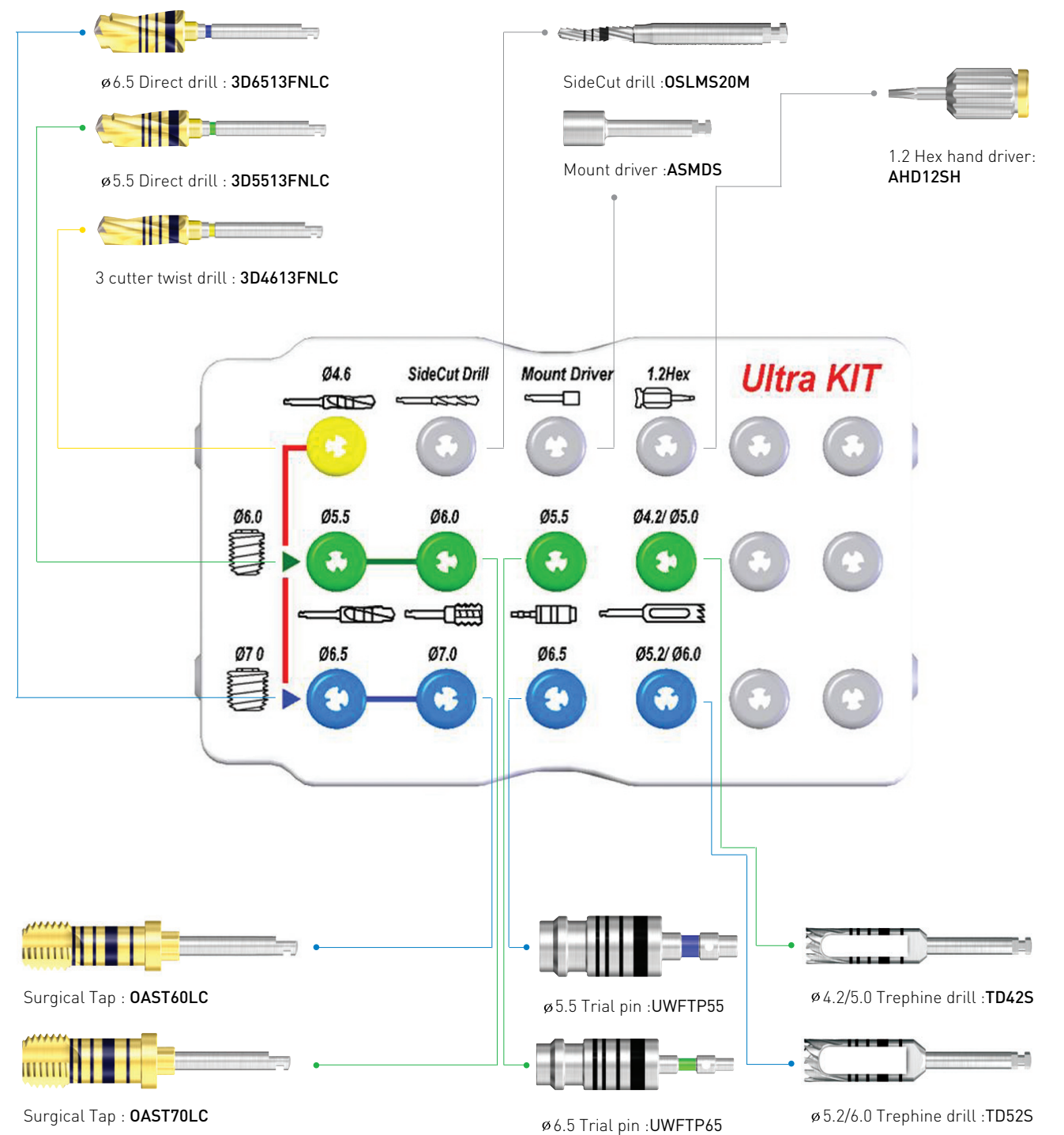

* Lower case component - Open wrench(ASOW) for Simple mount

Instrument Dimension Indication

* Drill & Surgical tap

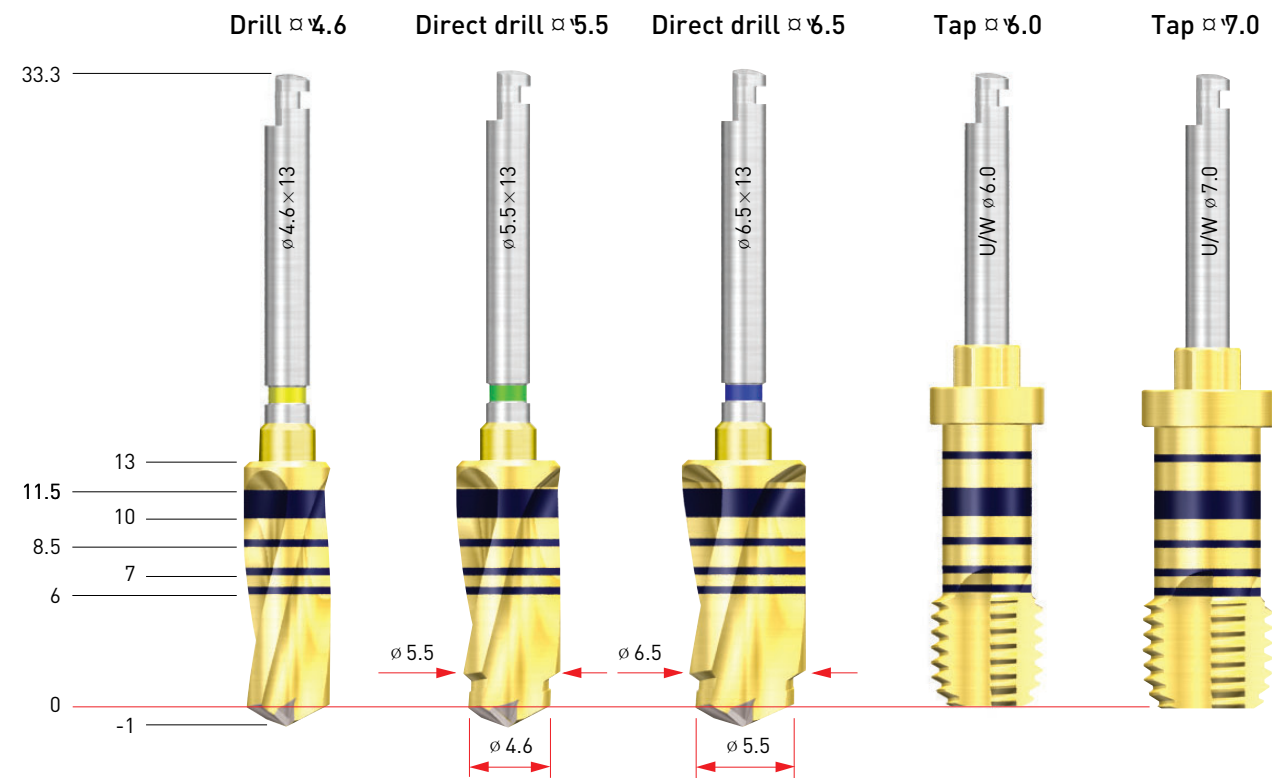

- Direct drill - 2-step drill has two functions - pilot drill & twist drill

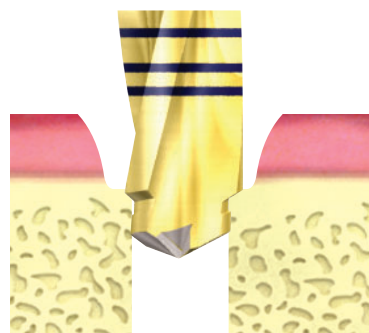

Enables final drilling directly without pilot drilling

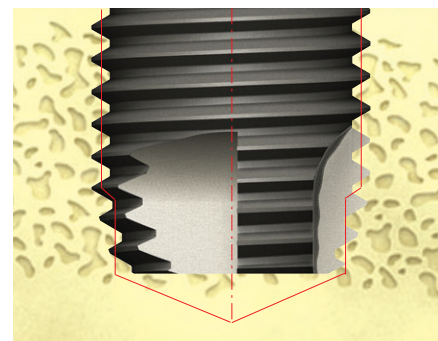

Enhancement of initial stability in the extract socket by decreasing the dead space at the apex area

Instrument Dimension Indication

* Trepine drill

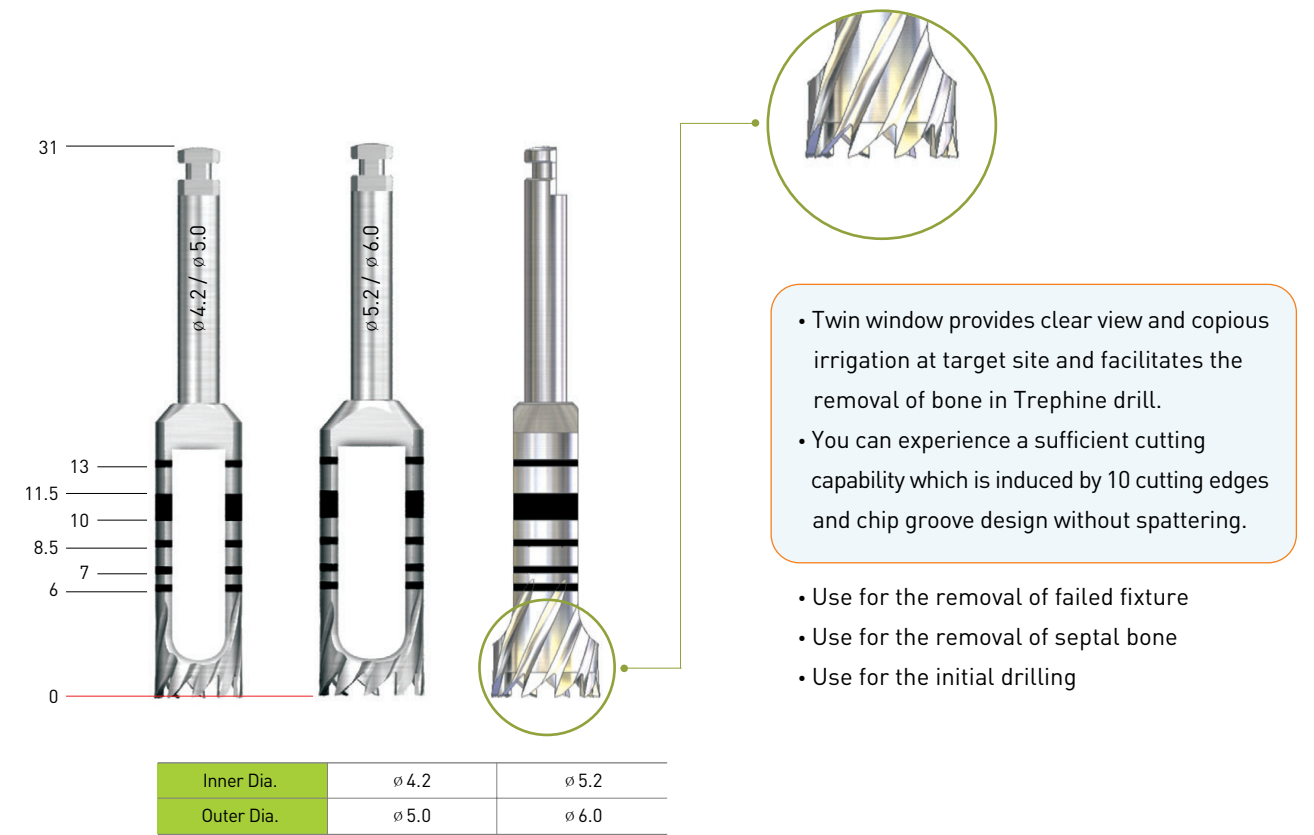

- Twin window provides clear view and copious irrigation at target site and facilitates the removal of bone in Trepine drill.
- You can experience a sufficient cutting capability which is induced by 10 cutting edges and chip groove design without spattering.

- Use for the removal of failed fixture
- Use for the removal of septal bone
- Use for the initial drilling

* Trial pin

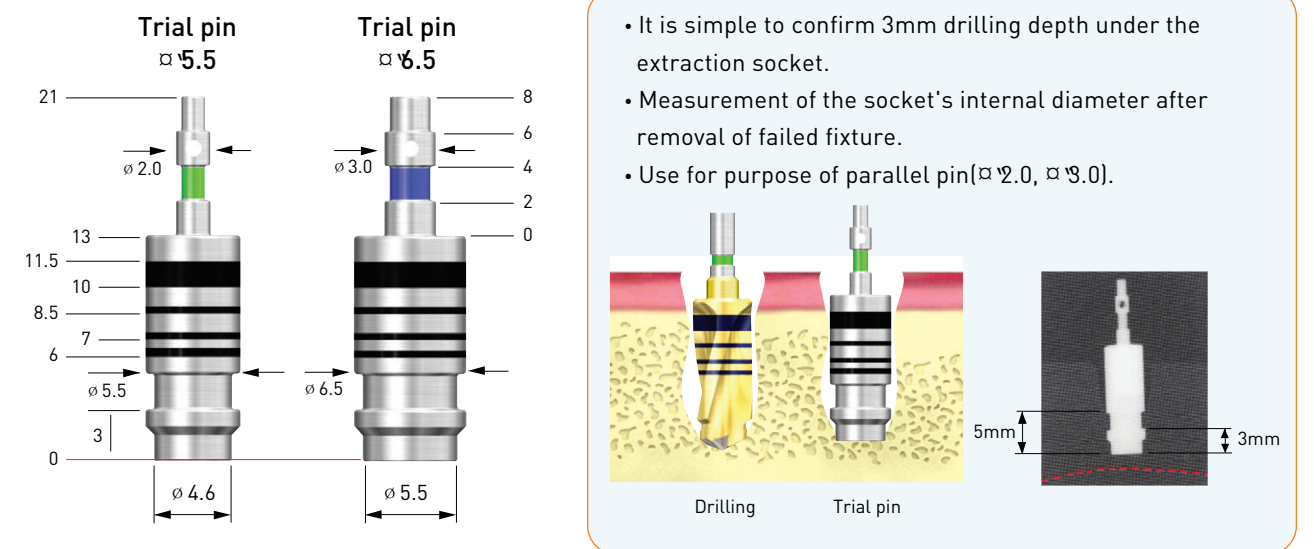

- It is simple to confirm 3mm drilling depth under the extraction socket.
- Measurement of the socket's internal diameter after removal of failed fixture.
- Use for purpose of parallel pin (ø 2.0, ø 3.0).

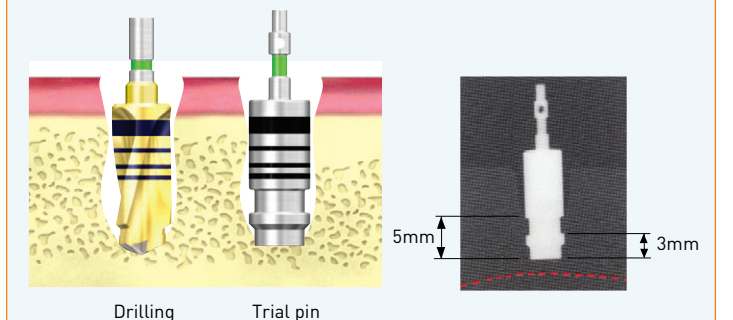

Surgical Procedure

The operator must check the following items before starting the surgery.

Patient's condition

- Sufficient bone volume and quality prior to treatment
- Smoking and/or drinking habits
- Status of oral hygiene
- Patient's understanding of implant surgery
- Detailed health status
- Masticatory pattern and habit
- Psychological state

Treatment Plan

Discuss treatment options with your patient. Include the pros and cons of each treatment as well as the procedure involved.

Medical Diagnosis

Check the patient's health history before implant surgery. Discuss the treatment plan and health history with the patient's primary care physician before performing surgery.

Pay Particular Attention to the Following during an Implant Procedure

- Improper upper/lower posterior height
- Extremely poor bone quality
- Ischemic heart patient (angina, myocardial infarction)
- Patient's distrust of implant treatment
- Improper lower anterior width
- Congenital or acquired heart conditions
- High blood pressure

How to Maintain Surgical KIT

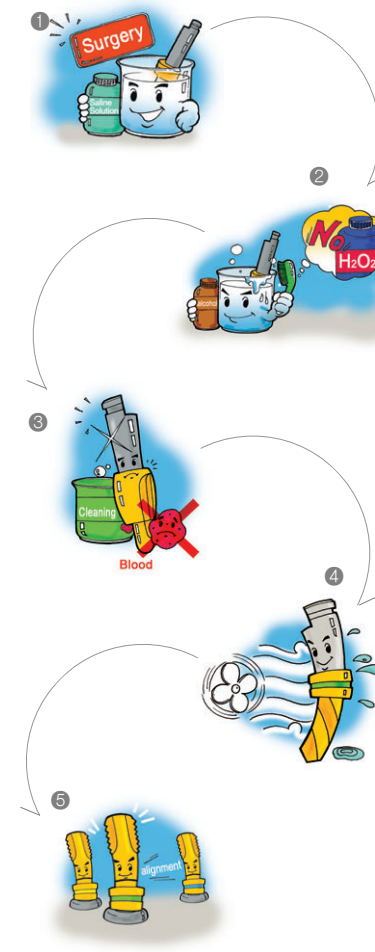

- ① During surgery, be sure to keep used tools in saline or distilled water.
- ② Rinse tools with distilled or running water to remove all blood and debris.
- ③ Alcohol wash all tools used in surgery
Caution: Do NOT use hydrogen peroxide
*Exposure to hydrogen peroxide may cause discoloration to laser markings and/or TiN coating
- ④ Remove all moisture with a dry cloth or warming fan
- ⑤ Replace dried tools into the Kit case
(Refer to the color-coding for easy placement.)
- ⑥ Autoclave Kit for 15 minutes at 132, then store at room temperature.

Precautions

Immediately after surgery separate, wash and store all tools.
Re-sterilize Kits prior to surgery (132 for 15 minutes)
Hanaro Kits have a 1 year product warranty (after opening); all drills and drivers are recommended for up to 50 uses.